

## A pocket-sized **companion**



## Index

1. Package contents	3
2. Product overview and functions	3
3. Safety instructions	3
4. First use	4
5. Make an alarm	5
6. Explanation of LED lights	5
7. Explanation of voice notifications	6
8. Technical specification	6
9. Recycling information	7

## Introduction

Thank you for using the SafetyTracer system. We have developed this application with the utmost care to enable you to sound the alarm when necessary. Unfortunately, despite all the precautions, you can end up in a situation where you are in need of help. SafetyTracer helps in such situations. You simply inform others and thus call in help. This manual has been prepared with the utmost care. If, in spite of this, there are imperfections or if you have other improvements or remarks, please let us know.

## 1. Package contents

1. Kompy Nano
2. Kompy Nano Wristband
3. Magnetisch Charging Cable
4. Power Adapter



## 2. Product overview

1. Panic Button
2. GSM LED Light
3. GPS LED Light
4. Microphone
5. Speaker
6. Charging Contact Pins
7. Heart Rate Sensor
8. On/Off (Call) Button

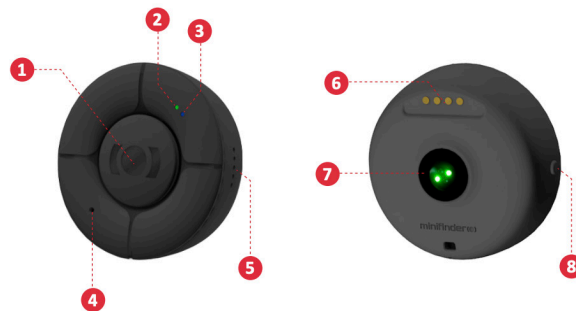

## 3. Safety instructions

Please read these safety instructions and user manual carefully before using the Kompy Nano. Keep this user manual for reference when needed.

### Information

Please follow the safety instructions given in this manual, If there are any questions or ambiguities, please contact your supplier. General information can be found at [www.safetytracer.eu](http://www.safetytracer.eu)

### Safety precautions

For the correct and safe installation and use of the Kompy Nano, it is essential that you follow the generally accepted safety measures in addition to the additional safety information in this manual. Additional warnings and safety notes, if applicable, are included in this manual. Warning and safety texts and / or symbols have been placed on the equipment if necessary.

### Safety statement

This equipment has been tested to comply with safety certificate in accordance with the specifications of standard: EN 60950: 2006 + A12: 2011.

## Liability

SafetyTracer BV reserves the right to change data and / or specifications of any device or software mentioned in this publication without prior notification. Despite all the care that is devoted to the correctness of this publication, SafetyTracer BV is not liable for damage caused by incorrect use or contempt of this publication.

Important safety instructions:

- Read all safety instructions and manuals carefully before proceeding to use.
- Save all safety instructions and manuals for future reference.
- All warnings on the equipment and in the manuals must be followed because of personal safety.
- Never clean the Kompy Nano with liquid detergents or cleaning agents from an aerosol dispenser, but use a damp cloth to clean.
- Do not connect any equipment other than the equipment recommended by SafetyTracer.
- Deviating from the recommendations may lead to malfunctioning of equipment and systems.
- Do not place the equipment without extra protection in humid environments or outdoors if it is not explicitly stated that the device has been designed for this purpose.
- Do not expose the equipment to extreme temperatures or humidity.
- Do not expose the equipment to strong magnetic and electromagnetic fields.
- Do not place the equipment on an unstable or vibrating surface.
- Do not place heavy objects on the equipment.
- Avoid strong shocks during transport.
- The equipment may only be supplied with a power supply in accordance with the equipment specification.
- By opening or removing housing, live parts can be touched.
- Do not attempt to maintain or repair the equipment independently. Maintenance and repair work must be carried out by suitably trained and qualified personnel.

## 4. First use

Before the Kompy Nano can be used, you must carry out the following steps.

### Charging

- Before using the Kompy Nano please charge it for 4 hours. During charging the blue LED is steady.
- The blue LED light goes out when the Kompy Nano is fully charged.
- Start the Kompy Nano by pressing ON/OFF button for 3 seconds.
- Turn off the Kompy Nano by pressing and holding SOS and ON/OFF buttons for 3 seconds.
- Place the magnetic charging cable to the charging pins to charge the Kompy Nano. See the picture below.

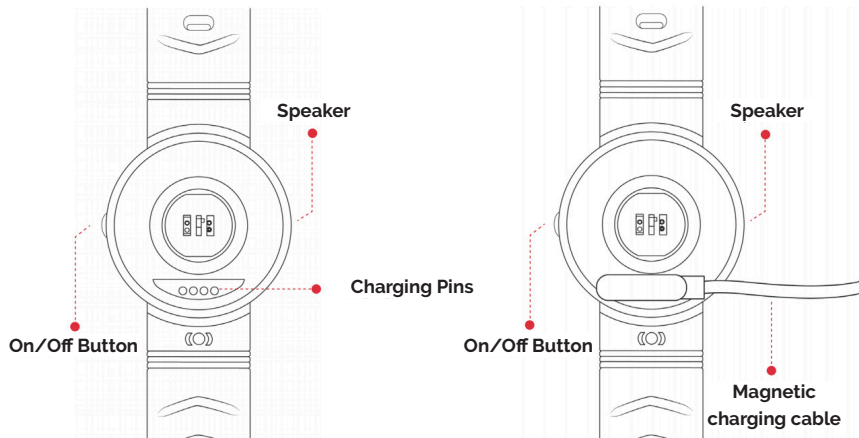

## 5. Make an alarm

An alarm will be created by pressing and holding the alarm button for 3 seconds. There will be a beep sound and the green light of the Kompy Nano starts blinking.

When the alarm is activated, the alarm will be automatically forwarded in our platform to the appropriate caregivers or care center.

As long as an alarm has not been accepted and handled by the caregiver, the Kompy Nano remains the alarm. In this alarm phase, a new alarm call is not possible.

If the alarm is accepted by the caregiver, a voice connection can be made to start a conversation. If the caregiver calls to the Kompy Nano, a conversation will be established.

## 6. Explanation of LED lights

Green LED

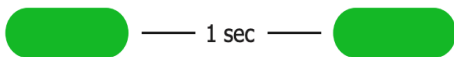

Slow blink = Searching for GSM network

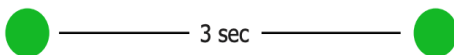

Single blink = Connected to GSM network

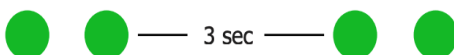

Double blink = Connected to GPRS network



Steady light = No or faulty SIM card

## Blue LED

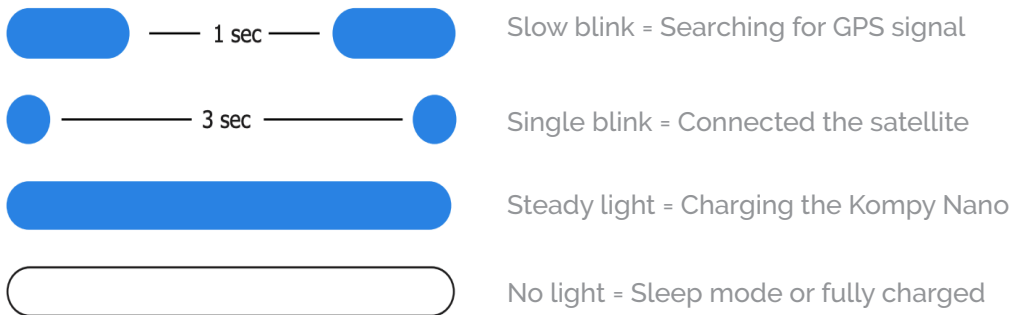

## 7. Explanation of voice notifications

1. The Kompy is on = The Kompy Nano is active and making an alarm is possible.
2. The Kompy goes off = The Kompy Nano is off and making an alarm is not possible anymore.
3. The Kompy's battery is low = The battery of the Kompy Nano is low. Notification is repeated 3 times.
4. The Kompy is charging = The Kompy Nano starts charging.
5. Fall alarm had been activated, press the alarm button to stop = The Kompy Nano had detected a fall. Click the SOS button to cancel the alarm.

## 8. Technical specification

<b>Size</b>	41 mm x 16 mm
<b>Weight</b>	23g
<b>Battery</b>	3,7V 380mAh, rechargeable
<b>Standby</b>	120 hours
<b>Operating Temperature</b>	-20°C tot +70°C
<b>IP Class</b>	IP66
<b>Approval</b>	in accordance with the standard R&TTE 99/CE/05

## 9. Recycling information



The symbol on the product or its packaging means that this product must be disposed of separately from ordinary household wastes at its end of life. Please be aware that this is your responsibility to dispose the electronic equipment at recycling centres to help conserve natural resources.

For more information about your recycling drop off point, please contact your local electrical and electronic equipment waste management authority or the retailer where you bought the product.

- Do not dispose of the Kompy Nano with household waste.
- Batteries are not to be disposed of in municipal waste stream and require separate collection.
- Disposal of the packaging and you Kompy Nano should be done in accordance with local regulations.